



Ligao Safety Valve and Back Pressure Valve



★ Introduction

Safety Valve Series:

Pressure relief valve is often called as safety valve or safety relief valve, is according to the working pressure system automatic opening and closing, generally installed in the closed system equipment or pipeline protection system safety. When the pressure in the equipment or pipeline exceeds the set pressure of the pressure relief valve, the pressure relief shall be automatically opened to ensure that the medium pressure in the equipment and the pipeline is under the set pressure to protect the normal operation of the equipment and pipeline to prevent accidents and reduce the loss.

Back Pressure Valve Series:

Back pressure valve is also diaphragm valve, which will make the system have steady pressure. The shape appearance is same as safety valve. But flow direction is opposite against to safety valve. The pressure adjust range is from 0.1-0.6Mpa.

★ Features

Valve Body Material: PVC/PVDF/SS304/SS316

Diaphragm Material: Composite PTFE

Safety Valve Working Pressure: 0.1-1Mpa (PVC/PVDF) ; 0.1-2.5Mpa; 0.1-10Mpa(SS material)

Back Pressure Valve Working Pressure: 0.1-1Mpa

Size: DN15;DN20;DN25;DN32;DN40;DN50;DN65;DN80;DN100

Connection type: Union/Female Thread/Flange

★ Parameters

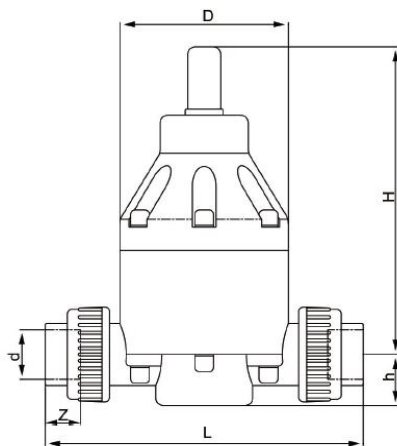

Safety Valve and Back Pressure Valve(PVC/PVDF)

Model	Material	Size	Dimensions(mm)					
			L	H	D	d	z	h
18615	PVC/PVDF	DN15	166	154	82	20	18	27
18620	PVC/PVDF	DN20	170	173	82	25	21	27
18625	PVC/PVDF	DN25	212	173	107	32	26	35
18632	PVC/PVDF	DN32	226	173	107	40	28	35
18640	PVC/PVDF	DN40	292	225	148	50	37	58
18650	PVC/PVDF	DN50	305	225	148	63	37	58
18665	PVC/PVDF	DN65	390	225	148	75	42	58

Back Pressue Valve(SS304/316)

Model	Material	Size	Pressure	Dimension		
				Thread	Flange	H(mm)
				L(mm)	H(mm)	
RXBF-S6/1.0	SS304/SS316	DN6	0.1-1Mpa	64.7		80
RXBF-S8/1.0	SS304/SS316	DN8	0.1-1Mpa	64.7		85
RXBF-S10/1.0	SS304/SS316	DN10	0.1-1Mpa	64.7		90
RXBF-S15/1.0	SS304/SS316	DN15	0.1-1Mpa	64.7	143	92
RXBF-S20/1.0	SS304/SS316	DN20	0.1-1Mpa	86.8	176	125
RXBF-S25/1.0	SS304/SS316	DN25	0.1-1Mpa	86.8	176	125
RXBF-S32/1.0	SS304/SS316	DN32	0.1-1Mpa	117.6	221	169
RXBF-S40/1.0	SS304/SS316	DN40	0.1-1Mpa	136.6	242	250
RXBF-S50/1.0	SS304/SS316	DN50	0.1-1Mpa	164.4	291	270
RXBF-S65/1.0	SS304/SS316	DN65	0.1-1Mpa	178	314	300
RXBF-S80/1.0	SS304/SS316	DN80	0.1-1Mpa	230	374	410
RXBF-S100/1.0	SS304/SS316	DN100	0.1-1Mpa	217/273	400	450

Safety Pressue Valve(SS304/SS316)

Model	Material	Size	Pressure	Dimension		
				Thread	Flange	H(mm)
				L(mm)	H(mm)	
RXAF-S6/2.5	SS304/SS316	DN6	0.1-2.5Mpa	64.7	/	80
RXAF-S8/2.5	SS304/SS316	DN8	0.1-2.5Mpa	64.7	/	85
RXAF-S10/2.5	SS304/SS316	DN10	0.1-2.5Mpa	64.7	/	90
RXAF-S15/2.5	SS304/SS316	DN15	0.1-2.5Mpa	64.7	143	92
RXAF-S20/2.5	SS304/SS316	DN20	0.1-2.5Mpa	86.8	176	125
RXAF-S25/2.5	SS304/SS316	DN25	0.1-2.5Mpa	86.8	176	125
RXAF-S32/2.5	SS304/SS316	DN32	0.1-2.5Mpa	117.6	221	169
RXAF-S40/2.5	SS304/SS316	DN40	0.1-2.5Mpa	136.6	242	250
RXAF-S50/2.5	SS304/SS316	DN50	0.1-2.5Mpa	164.4	291	270
RXAF-S65/2.0	SS304/SS316	DN65	0.1-2Mpa	178	314	300
RXAF-S80/2.0	SS304/SS316	DN80	0.1-2Mpa	230	374	410
RXAF-S100/2.0	SS304/SS316	DN100	0.1-2Mpa	217/273	400	450
RXAF-S6/10	SS304/SS316	DN6	0.1-10Mpa	64.7	/	80
RXAF-S8/10	SS304/SS316	DN8	0.1-10Mpa	64.7	/	85
RXAF-S10/10	SS304/SS316	DN10	0.1-10Mpa	64.7	/	90
RXAF-S15/10	SS304/SS316	DN15	0.1-10Mpa	64.7	143	92
RXAF-S20/10	SS304/SS316	DN20	0.1-10Mpa	86.8	176	125
RXAF-S25/10	SS304/SS316	DN25	0.1-10Mpa	86.8	176	125
RXAF-S32/10	SS304/SS316	DN32	0.1-10Mpa	117.6	221	169
RXAF-S40/10	SS304/SS316	DN40	0.1-10Mpa	136.6	242	250

T Shape Pressue Valve(SS304/SS316)

Model	Size	Connetion	Pressure (Mpa)	Material
DN15	DN15	Union	3.5-51Mpa	SS304/SS316
		Union	51-155Mpa	

